

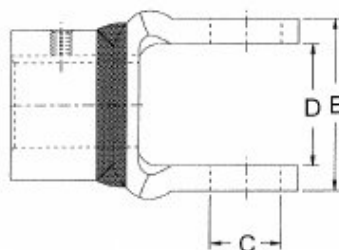

UNIVERSAL JOINT YOKE ID & HP RATING



$$HP = \frac{\text{Torque (LB. FT.)} \times \text{RPM}}{5252}$$

$$\text{TORQUE (LB. FT.)} = \frac{HP \times 5252}{\text{RPM}}$$

Surplus Center Item Number	Series No.	C	D	E	Bearing Type	Torque Lb - Ft	Torque Lb - In	HP @ 540 RPM	Max. Oper. Angle @ 540 RPM	HP @ 1000 RPM	Max Oper. Angle @ 1000 RPM
1-2728	4P	7/8	1-23/64	**	Plain	48.62	583	5	15°	9	7°
1-2729 1-2730	6N	31/32	1-7/16	**	Needle	116.71	1400	12	15°	22	7°
1-2731 1-2732	12N	1-1/16	1-13/16	**	Needle	272.33	3268	28	15°	52	7°

** Not a critical dimension for location of snap ring.

CROSS REFERENCE INFORMATION

G&G	Rockwell Standard	Weasler Engineering	Neapco	Spicer	Walterscheid AgMaster	G&G Repair Kit No.
4P						302-0400
6N	CPL6R-40	200-0600 L6W/6RW	1-1475		5-92X	302-0600
	L6N	6	L600			
12N	CPL12R	200-1200 12RW	1-1275		5-242X	302-1200
	L12N	12	1200	1140	1140	