

Type BS (Bored to Size) Hardened Teeth - 2 Setscrews

- Black Oxide Finish
- Keyway is on center line of tooth
- Setscrews are on keyway and 90°
- Hub sizes vary to suit different bore

Keyway Dimensions		
Bore Size	Keyway Width x Depth	Setscrew
1/2	1/8 X 1/16	10-24
5/8 - 7/8	3/16 X 3/32	1/4
15/16 - 1 1/4	1/4 X 1/8	5/16
1 5/16 - 1 3/8	5/16 X 5/32	5/16
1 7/16 - 1 3/4	3/8 X 3/16	3/8
1 13/16 - 2 1/4	1/2 X 1/4	1/2

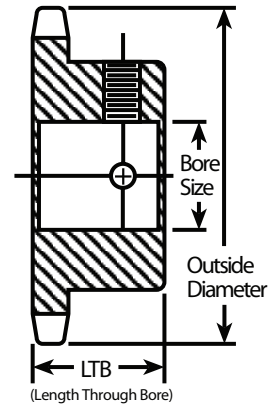

40-1 FOR 1/2" PITCH ANSI CHAIN

Teeth No.	Item #	Outside Dia. (in.)	LTB (in.)	Hub Dia. (in.)	Finished Bores											
					1/2	5/8	3/4	7/8	1	1 1/8	1 3/16	1 1/4	1 3/8	1 7/16	1 1/2	
10	1-2123-10	1.84	7/8	1 1/4*	A	B	C									
11	1-2123-11	2.00	7/8	1 3/8*	A	B	C	D								
12	1-2123-12	2.17	7/8	1 9/16*	A	B	C	D	E							
13	1-2123-13	2.33	7/8	1 9/16	A	B	C	D	E							
14	1-2123-14	2.49	7/8	1 11/16	A	B	C	D	E	F	G					
15	1-2123-15	2.65	7/8	1 13/16	A	B	C	D	E	F	G	H				
16	1-2123-16	2.81	7/8	2		B	C	D	E	F	G	H				
17	1-2123-17	2.98	1	2 1/8		B	C	D	E	F	G	H				
18	1-2123-18	3.14	1	2 5/16		B	C	D	E	F	G	H	I	J	K	
19	1-2123-19	3.30	1	2 1/2		B	C	D	E	F	G	H	I	J	K	
20	1-2123-20	3.46	1	2 5/8		B	C	D	E	F	G	H	I	J	K	
21	1-2123-21	3.62	1	2 3/4		B	C		E	F	G	H	I	J	K	
22	1-2123-22	3.78	1	2 7/8		B	C	D	E	F	G	H		J	K	
23	1-2123-23	3.94	1	3		B	C	D	E		G	H	I	J	K	
24	1-2123-24	4.10	1	3 1/4		B	C	D	E	F	G	H	I	J	K	
25	1-2123-25	4.26	1	3 1/4			C	D	E	F	G	H			K	
26	1-2123-26	4.42	1	3 1/4			C	D	E	F	G	H			K	
27	1-2123-27	4.58	1	3 1/4			C	D	E	F	G	H			K	
28	1-2123-28	4.74	1	3 1/4			C	D	E	F	G	H			K	
29	1-2123-29	4.90	1	3 1/4			C	D	E	F	G	H			K	
30	1-2123-30	5.06	1	3 1/4			C	D	E	F	G	H			K	

*Has recessed groove in the hub for chain clearance. Maximum bores shown will accommodate the standard keyseat and setscrew over keyseat.