

Type BS (Bored to Size) Hardened Teeth - 2 Setscrews

- Black Oxide Finish
- Keyway is on center line of tooth
- Setscrews are on keyway and 90°
- Hub sizes vary to suit different bore

Keyway Dimensions		
Bore Size	Keyway Width x Depth	Setscrew
1/2 - 9/16	1/8 X 1/16	10-24
5/8 - 7/8	3/16 X 3/32	1/4
1 1/16 - 1 1/4	1/4 X 1/8	5/16
1 5/16 - 1 3/8	5/16 X 5/32	5/16
1 7/16 - 1 3/4	3/8 X 3/16	3/8
1 13/16 - 2 1/4	1/2 X 1/4	1/2

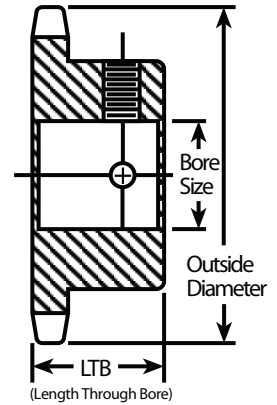

50-1 FOR 5/8" PITCH ANSI CHAIN

Teeth No.	Item #	Outside Dia. (in.)	LTB (in.)	Hub Dia. (in.)	Finished Bores												
					5/8	3/4	7/8	1	1 1/8	1 3/16	1 1/4	1 3/8	1 7/16	1 1/2	1 5/8		
10	1-2124-10	2.30	1	1 9/16*	B	C	D	E									
11	1-2124-11	2.50	1	1 3/4*	B	C	D	E									
12	1-2124-12	2.71	1	1 63/64	B	C	D	E	F	G	H						
13	1-2124-13	2.91	1	1 7/8	B	C	D	E	F	G	H						
14	1-2124-14	3.11	1	2 1/8	B	C	D	E	F	G	H						
15	1-2124-15	3.32	1	2 3/8	B	C	D	E	F	G	H	I	J	K			
16	1-2124-16	3.52	1	2 1/2	B	C	D	E	F	G	H	I	J	K			
17	1-2124-17	3.72	1	2 11/16	B	C	D	E	F	G	H	I	J	K			
18	1-2124-18	3.92	1	2 7/8	B	C	D	E	F	G	H	I	J	K			
19	1-2124-19	4.12	1	3	B	C	D	E	F	G	H	I	J	K	L		
20	1-2124-20	4.32	1	3		C	D	E	F	G	H	I	J	K			
21	1-2124-21	4.52	1	3		C	D	E	F	G	H	I	J	K			
22	1-2124-22	4.72	1	3		C	D	E	F	G	H	I	J	K			
23	1-2124-23	4.92	1	3		C	D	E	F	G	H	I	J	K			
24	1-2124-24	5.12	1 1/4	3		C	D	E	F	G	H	I	J	K			
25	1-2124-25	5.32	1 1/4	3		C	D	E	F	G	H	I	J	K			
26	1-2124-26	5.52	1 1/4	3		C	D	E	F	G	H	I	J	K			
27	1-2124-27	5.72	1 1/4	3		C	D	E	F	G	H	I	J	K			
28	1-2124-28	5.92	1 1/4	3		C	D	E	F	G	H	I	J	K			
30	1-2124-30	6.32	1 1/4	3 1/4		C	D	E	F	G	H	I	J	K			
34	1-2124-34	7.12	1 1/4	3 1/4		C	D	E	F	G	H	I	J	K			
40	1-2124-40	8.32	1 1/4	3 1/4		C	D	E	F	G	H	I	J	K			

*Has recessed groove in the hub for chain clearance. Maximum bores shown will accommodate the standard keyseat and setscrew over keyseat.