

Type BS (Bored to Size) Hardened Teeth - 2 Setscrews

- Black Oxide Finish
- Keyway is on center line of tooth
- Setscrews are on keyway and 90°
- Hub sizes vary to suit different bore sizes

Keyway Dimensions		
Bore Size	Keyway Width x Depth	Setscrew
1/2 - 9/16	1/8 x 1/16	10-24
5/8 - 7/8	3/16 x 3/32	1/4
15/16 - 1 1/4	1/4 x 1/8	5/16
1 5/16 - 1 3/8	5/16 x 5/32	5/16
1 7/16 - 1 3/4	3/8 x 3/16	3/8
1 13/16 - 2 1/4	1/2 x 1/4	1/2

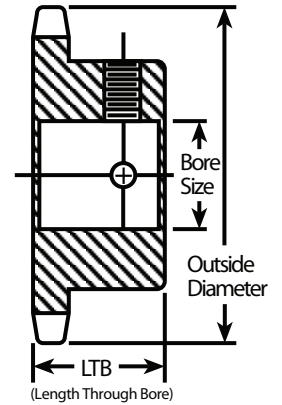

80-1 FOR 1" PITCH ANSI CHAIN

Teeth No.	Item #	Outside Dia. (in.)	LTB (in.)	Hub Dia. (in.)	Finished Bores															
					1	1 1/8	1 3/16	1 1/4	1 3/8	1 7/16	1 1/2	1 5/8	1 3/4	1 7/8	1 15/16	2				
10	1-2145-10	3.68	1 5/8	2 9/16*	E	F	G	H			K									
11	1-2145-11	4.01	1 5/8	2 13/16*	E	F	G	H		J	K				O					
12	1-2145-12	4.33	1 5/8	3 1/8*	E	F	G	H	I	J	K	L	M							
13	1-2145-13	4.66	1 1/2	3	E	F	G	H	I	J	K	L	M				P			
14	1-2145-14	4.98	1 1/2	3 1/4	E	F	G	H	I	J	K	L	M	N			P			
15	1-2145-15	5.30	1 1/2	3 13/16	E	F	G	H	I	J	K	L	M				P			
16	1-2145-16	5.63	1 1/2	4	E	F	G	H	I	J	K	L	M	N	O	P				
17	1-2145-17	5.95	1 1/2	4	E	F	G	H	I	J	K	L	M	N	O	P				
18	1-2145-18	6.27	1 1/2	4 1/4	E	F	G	H	I	J	K	L	M	N	O	P				
19	1-2145-19	6.59	1 1/2	4 1/4	E	F	G	H	I	J	K	L	M	N	O	P				
20	1-2145-20	6.91	1 1/2	4 1/4	E	F	G	H	I	J	K	L	M	N	O	P				

*Has recessed groove in the hub for chain clearance. Maximum bores shown will accommodate the standard keyseat and setscrew over keyseat.