

Type BS (Bored to Size) Hardened Teeth - 2 Setscrews

- Black Oxide Finish
- Keyway is on center line of tooth
- Setscrews are on keyway and 90°
- Hub sizes vary to suit different bore sizes

Keyway Dimensions		
Bore Size	Keyway Width x Depth	Setscrew
1/2 - 9/16	1/8 X 1/16	10-24
5/8 - 7/8	3/16 X 3/32	1/4
15/16 - 1 1/4	1/4 X 1/8	5/16
1 5/16 - 1 3/8	5/16 X 5/32	5/16
1 7/16 - 1 3/4	3/8 X 3/16	3/8
1 13/16 - 2 1/4	1/2 X 1/4	1/2

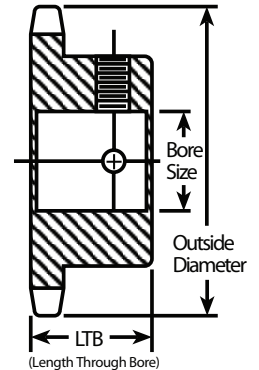

35-1 FOR 3/8" PITCH ANSI CHAIN

Teeth No.	Item #	Outside Dia. (in.)	LTB (in.)	Hub Dia. (in.)	Finished Bores									
					3/8	1/2	5/8	3/4	7/8	1	1 1/8	1 3/16	1 1/4	
10	1-2413-10	1.38	3/4	31/32*	AA	A	B							
11	1-2413-11	1.50	3/4	11/16*	AA	A	B	C						
12	1-2413-12	1.63	3/4	17/32*		A	B	C						
13	1-2413-13	1.75	3/4	11/4*		A	B	C						
14	1-2413-14	1.87	3/4	11/4		A	B	C						
15	1-2413-15	1.99	3/4	111/32		A	B	C	D	E				
16	1-2413-16	2.11	3/4	115/32		A	B	C	D	E				
17	1-2413-17	2.23	3/4	119/32		A	B	C	D	E				
18	1-2413-18	2.35	3/4	123/32		A	B	C	D	E				
19	1-2413-19	2.47	3/4	127/32		A	B	C		E				
20	1-2413-20	2.59	3/4	115/16		A	B	C		E				
21	1-2413-21	2.71	7/8	2		A	B	C		E				
22	1-2413-22	2.83	7/8	2		A	B	C		E				
23	1-2413-23	2.95	7/8	2		A	B	C		E				
24	1-2413-24	3.07	7/8	2		A	B	C		E				
25	1-2413-25	3.19	7/8	2		A	B	C		E				
26	1-2413-26	3.31	7/8	2			B	C	D	E	F	G	H	
27	1-2413-27	3.43	7/8	2			B	C	D	E	F	G	H	
28	1-2413-28	3.55	7/8	2			B	C	D	E	F	G	H	
29	1-2413-29	3.66	7/8	2			B	C	D	E	F	G	H	
30	1-2413-30	3.79	7/8	2			B	C	D	E	F	G	H	
32	1-2413-32	4.03	7/8	2			B	C	D	E	F	G	H	
35	1-2413-35	4.39	7/8	2 1/4			B	C	D	E	F	G	H	
36	1-2413-36	4.51	7/8	2 1/4			B	C	D	E	F	G	H	
40	1-2413-40	4.99	1	2 1/4			B	C	D	E	F	G	H	
42	1-2413-42	5.23	1	2 1/4			B	C	D	E	F	G	H	
45	1-2413-45	5.59	1	2 1/4			B	C	D	E	F	G	H	
48	1-2413-48	5.95	1	2 1/4			B	C	D	E	F	G	H	
54	1-2413-54	6.66	1	2 1/4			B	C	D	E	F	G	H	
60	1-2413-60	7.38	1	2 1/4				C	D	E	F	G	H	
72	1-2413-72	8.81	1	2 1/4				C	D	E	F	G	H	

*Has recessed groove in the hub for chain clearance. Maximum bores shown will accommodate the standard keyseat and setscrew over keyseat.