

SINGLE GROOVE H SERIES BUSHED SHEAVES FOR 4L OR A (1/2") BELTS & 5L OR B (5/8") BELTS



Bushing is sold separately

Outside and Datum Diameters

These pulleys accept both 'A' (1/2") belts or 'B' (5/8") belts. The outside diameter is measured at the outside of pulley. The datum diameters are an industry standard reference point used for calculations such as center distance and belt length. The datum system replaces the pitch system for classical belts and pulleys to compensate for differences in manufacturers construction of belts.

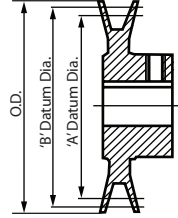

SINGLE GROOVE H SERIES BUSHED SHEAVES

Item #	Diameters			Type	Dimensions							
	Outside	Datum "A"	Datum "B"		OL	F	L	P	C	X	G	E
1-BKH30	3.15"	2.40"	2.80"	1	1 ¹⁵ / ₁₆ "	7/8"	1 ¹ / ₄ "	7/8"	-	1 ⁵ / ₁₆ "	7/16"	3/16"
1-BKH32	3.35"	2.60"	3.00"	1	1 ¹⁵ / ₁₆ "	7/8"	1 ¹ / ₄ "	7/8"	-	1 ⁵ / ₁₆ "	7/16"	3/16"
1-BKH34	3.55"	2.80"	3.20"	1	1 ¹⁵ / ₁₆ "	7/8"	1 ¹ / ₄ "	7/8"	-	1 ⁵ / ₁₆ "	7/16"	3/16"
1-BKH36	3.75"	3.00"	3.40"	2	1 ¹ / ₂ "	7/8"	1 ¹ / ₄ "	7/16"	-	7/8"	7/16"	3/16"
1-BKH40	3.95"	3.20"	3.60"	2	1 ¹ / ₂ "	7/8"	1 ¹ / ₄ "	7/16"	-	7/8"	7/16"	3/16"
1-BKH45	4.25"	3.50"	3.90"	2	1 ¹ / ₂ "	7/8"	1 ¹ / ₄ "	7/16"	-	7/8"	7/16"	3/16"
1-BKH47	4.45"	3.70"	4.10"	2	1 ¹ / ₂ "	7/8"	1 ¹ / ₄ "	7/16"	-	7/8"	7/16"	3/16"
1-BKH50	4.75"	4.00"	4.40"	2	1 ¹ / ₂ "	7/8"	1 ¹ / ₄ "	7/16"	-	7/8"	7/16"	3/16"
1-BKH52	4.95"	4.20"	4.60"	2	1 ¹ / ₂ "	7/8"	1 ¹ / ₄ "	7/16"	-	7/8"	7/16"	3/16"
1-BKH55	5.25"	4.50"	4.90"	2	1 ¹ / ₂ "	7/8"	1 ¹ / ₄ "	7/16"	-	7/8"	7/16"	3/16"
1-BKH57	5.45"	4.70"	5.10"	2	1 ¹ / ₂ "	7/8"	1 ¹ / ₄ "	7/16"	-	7/8"	7/16"	3/16"
1-BKH60	5.75"	5.00"	5.40"	2	1 ¹ / ₂ "	7/8"	1 ¹ / ₄ "	7/16"	-	7/8"	7/16"	3/16"
1-BKH62	5.95"	5.20"	5.60"	2	1 ¹ / ₂ "	7/8"	1 ¹ / ₄ "	7/16"	-	7/8"	7/16"	3/16"
1-BKH65	6.25"	5.50"	5.90"	2	1 ¹ / ₂ "	7/8"	1 ¹ / ₄ "	7/16"	-	7/8"	7/16"	3/16"
1-BKH67	6.45"	5.70"	6.10"	2	1 ¹ / ₂ "	7/8"	1 ¹ / ₄ "	7/16"	-	7/8"	7/16"	3/16"
1-BKH70	6.75"	6.00"	6.40"	3	1 ⁹ / ₁₆ "	7/8"	1 ¹ / ₄ "	1/2"	1/16"	7/8"	7/16"	3/16"
1-BKH72	6.95"	6.20"	6.60"	3	1 ⁹ / ₁₆ "	7/8"	1 ¹ / ₄ "	1/2"	1/16"	7/8"	7/16"	3/16"
1-BKH75	7.25"	6.50"	6.90"	3	1 ⁹ / ₁₆ "	7/8"	1 ¹ / ₄ "	1/2"	1/16"	7/8"	7/16"	3/16"
1-BKH77	7.45"	6.70"	7.10"	3	1 ⁹ / ₁₆ "	7/8"	1 ¹ / ₄ "	1/2"	1/16"	7/8"	7/16"	3/16"
1-BKH80	7.75"	7.00"	7.40"	3	1 ⁹ / ₁₆ "	7/8"	1 ¹ / ₄ "	1/2"	1/16"	7/8"	7/16"	3/16"
1-BKH85	8.25"	7.50"	7.90"	3	1 ⁹ / ₁₆ "	7/8"	1 ¹ / ₄ "	1/2"	1/16"	7/8"	7/16"	3/16"
1-BKH90	8.75"	8.00"	8.40"	3	1 ⁹ / ₁₆ "	7/8"	1 ¹ / ₄ "	1/2"	1/16"	7/8"	7/16"	3/16"
1-BKH95	9.25"	8.50"	8.90"	3	1 ⁹ / ₁₆ "	7/8"	1 ¹ / ₄ "	1/2"	1/16"	7/8"	7/16"	3/16"
1-BKH100	9.75"	9.00"	9.40"	3	1 ⁹ / ₁₆ "	7/8"	1 ¹ / ₄ "	1/2"	1/16"	7/8"	7/16"	3/16"
1-BKH105	10.25"	9.50"	9.90"	3	1 ⁹ / ₁₆ "	7/8"	1 ¹ / ₄ "	1/2"	1/16"	7/8"	7/16"	3/16"
1-BKH110	10.75"	10.00"	10.40"	3	1 ⁹ / ₁₆ "	7/8"	1 ¹ / ₄ "	1/2"	1/16"	7/8"	7/16"	3/16"
1-BKH115	11.25"	10.50"	10.90"	3	1 ⁹ / ₁₆ "	7/8"	1 ¹ / ₄ "	1/2"	1/16"	7/8"	7/16"	3/16"
1-BKH120	11.75"	11.00"	11.40"	3	1 ⁹ / ₁₆ "	7/8"	1 ¹ / ₄ "	1/2"	1/16"	7/8"	7/16"	3/16"
1-BKH130	12.75"	12.00"	12.40"	3	1 ⁹ / ₁₆ "	7/8"	1 ¹ / ₄ "	1/2"	1/16"	7/8"	7/16"	3/16"
1-BKH140	13.75"	13.00"	13.40"	3	1 ⁹ / ₁₆ "	7/8"	1 ¹ / ₄ "	1/2"	1/16"	7/8"	7/16"	3/16"
1-BKH150	14.75"	14.00"	14.40"	3	1 ⁹ / ₁₆ "	7/8"	1 ¹ / ₄ "	1/2"	1/16"	7/8"	7/16"	3/16"
1-BKH160	15.75"	15.00"	15.40"	3	1 ⁹ / ₁₆ "	7/8"	1 ¹ / ₄ "	1/2"	1/16"	7/8"	7/16"	3/16"
1-BKH190	18.75"	18.00"	18.40"	3	1 ⁹ / ₁₆ "	7/8"	1 ¹ / ₄ "	1/2"	1/16"	7/8"	7/16"	3/16"

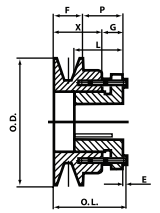

TYPE 1

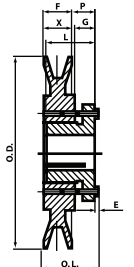

TYPE 2

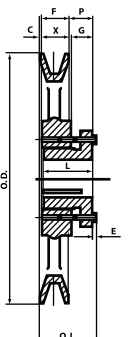

TYPE 3